

## IQ4300 Series Data Sheet

### Headset Overview

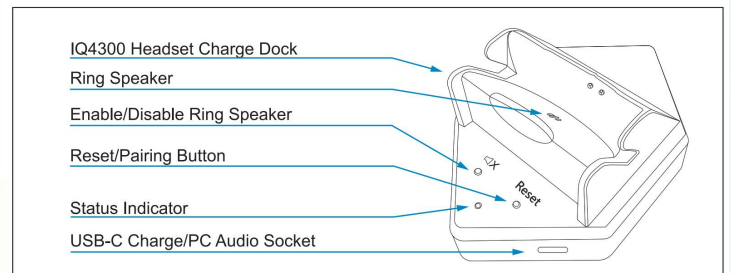
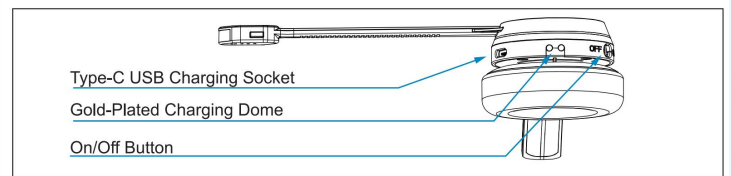
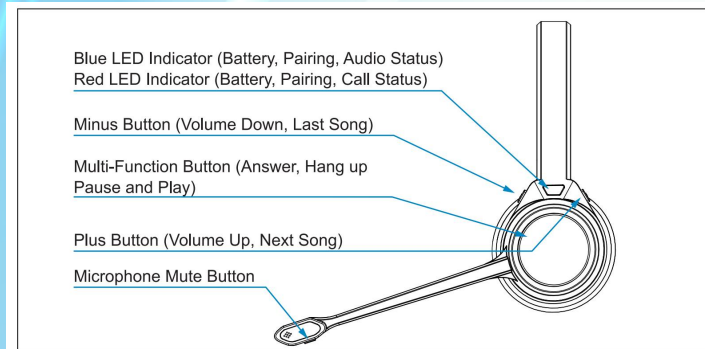

### Specifications

Bluetooth Specification: V5.2, dual mode, downward compatible  
Frequency Range: 2.4GHz-2.480Ghz  
Supported Protocols: A2DP, AVRCP, HFP, AAC  
Two Bluetooth devices can be connected at the same time  
Supports Dual connect corded USB and Bluetooth audio  
Transmission Distance: up to 30m (Transmission distance varies depending on the environment and Bluetooth device)  
Maximum Talk Time (70% volume): Binaural (40 hours)  
Monaural (22 hours)

Standby Time: 200 hours  
Working Temperature: 0°C to 45°C

### Speaker

Frequency: 20Hz-20KHz, Hi-Fi  
Distortion: ≤ 1%

### Sound Channel

Binaural: Stereo  
Monaural: Mono

### Microphone

Microphone: directional noise reduction microphone  
Acoustic Noise Cancelling Structure  
Digital Sound Processing (DSP) for sound and voice

### Headset Battery

Type: Lithium-ion-polymer  
Battery Capacity: Binaural (320mAh),  
Monaural (180mAh)  
Charging Voltage: 5V DC  
Lifetime: 1000 charge cycles (Minimum)  
Operating Temperature: -10°C to +60°C  
Charging Time: 2 hours  
Charging interface: Type-C USB

### Charging Base Net Weight

Net Weight: 113g

### Headset Weight

IQ4310 Mono: 84g  
IQ4330 Duo: 120g

### Warranty

12 months return to base